

3. INSTALACIÓN BAJO ENCIMERA 3. UNDERMOUNT INSTALLATION

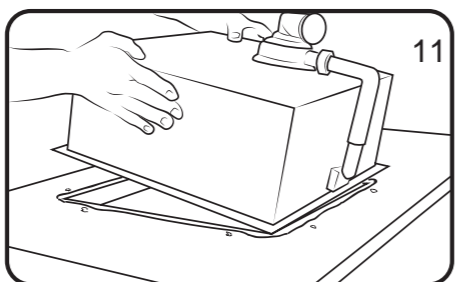

12

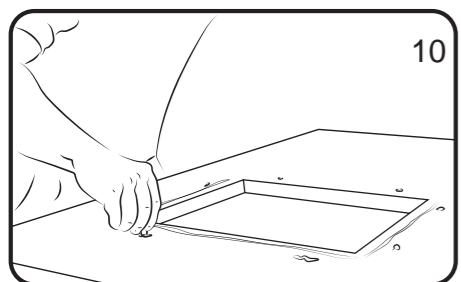
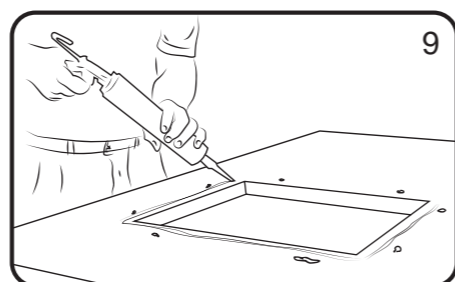
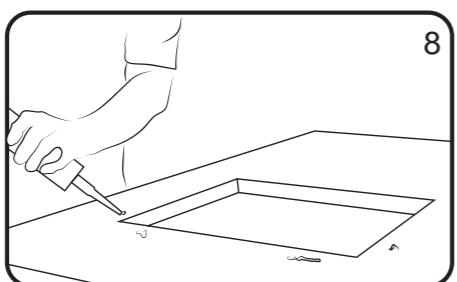
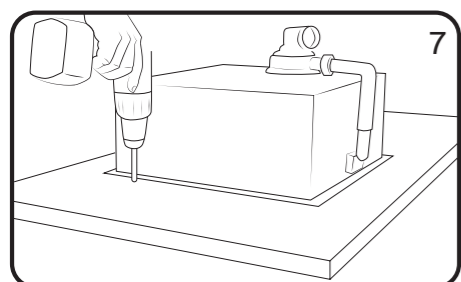
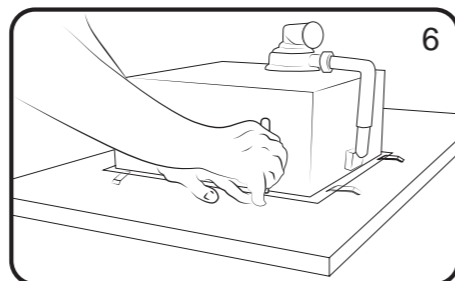
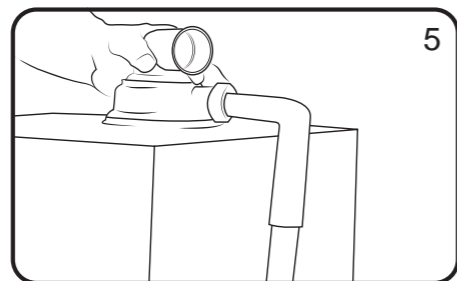
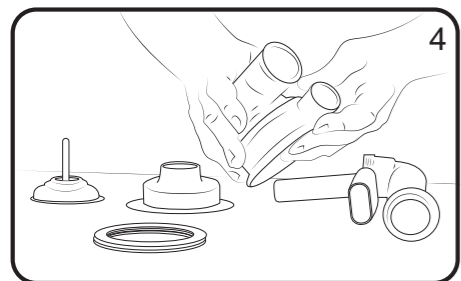
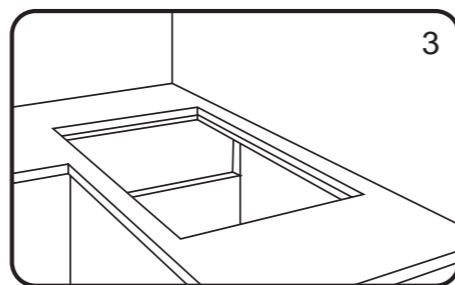
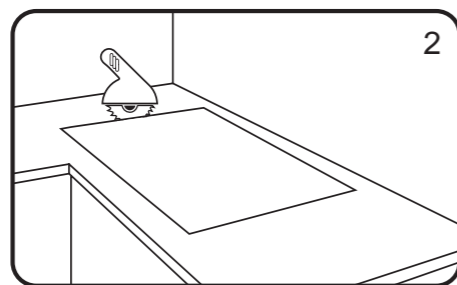
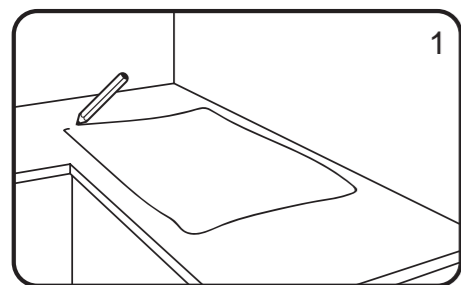
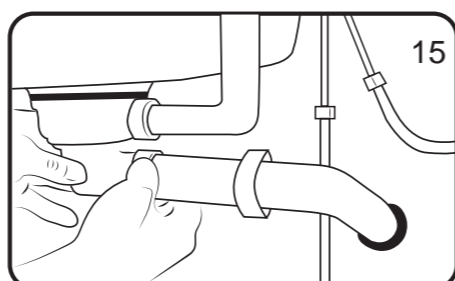
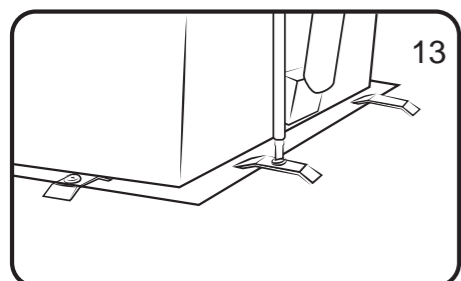

MANUAL DE INSTALACIÓN INSTALLATION MANUAL



MARTE 400 x 400
MARS 400 x 400

VENUS 500 x 400
VENUS 500 x 400

URANO 686 x 457
URANUS 686 x 457

NEPTUNO 838 x 457
NEPTUNE 838 x 457

Usted ha adquirido un fregadero fabricado con acero inoxidable SUS 304 de máxima calidad garantizado por vida (lea la hoja de garantía del producto).

Su fregadero lleva un aislamiento térmico y acústico en la parte posterior que evita la condensación y el ruido del agua.

You have acquired a sink made of the highest quality SUS 304 stainless steel, which features a lifetime warranty (please read the warranty of the product).

The sink has an acoustic and thermal isolation on the back side, in order to avoid condensation and the water noise.

Antes de empezar la instalación revise su fregadero:

- Posibles golpes en el transporte
- Rayas o acabado no conforme

IMPORTANT! No instale el fregadero si observa algún daño.

Before installing the sink, please check:

- Possible dents during the transportation
- Scratches or undesirable nishes

IMPORTANT! It is strongly advisable not to install the sink, in case you notice any damage

MATERIAL SUMINISTRADO COMPONENTS INCLUDED

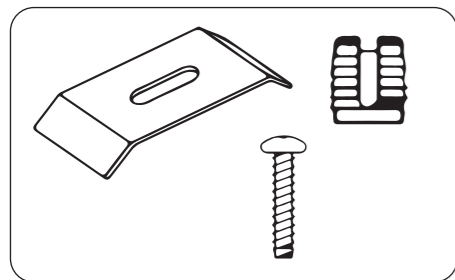

x 6

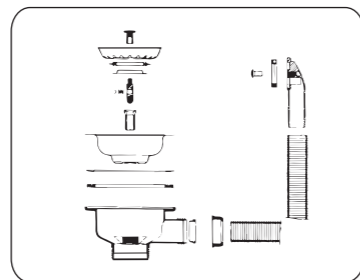

x 1

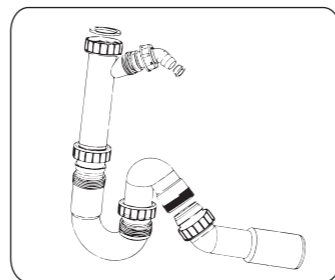

x 1

TIPOS DE INTALACIÓN:

1. INSTALACIÓN SLIM (ENCASTRADO)

TYPES OF INSTALLATION:

1. SLIM

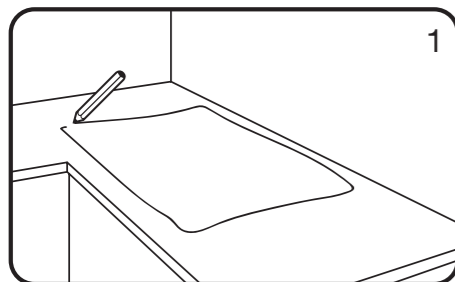

1

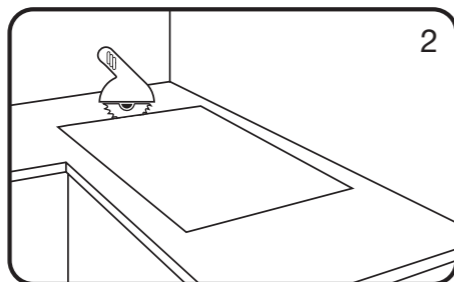

2

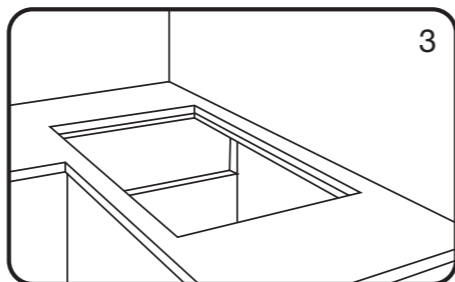

3

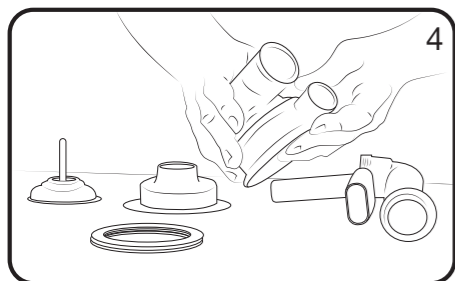

4

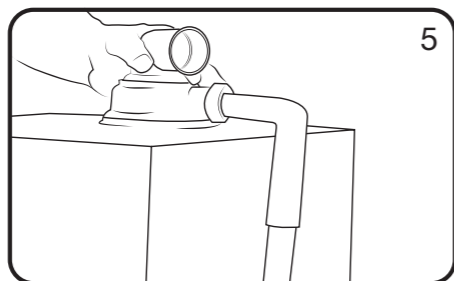

5

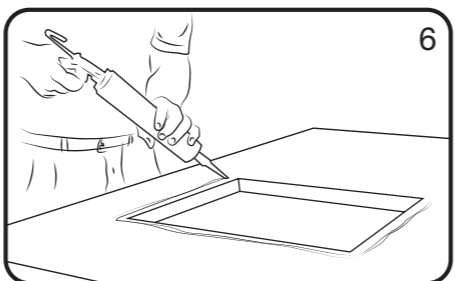

6

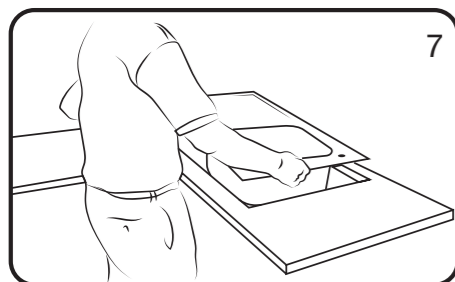

7

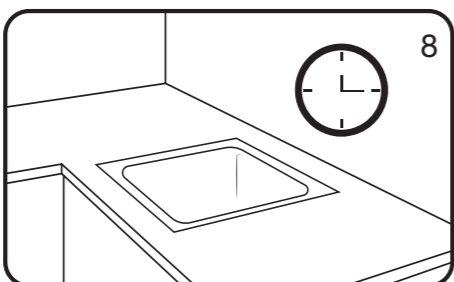

8

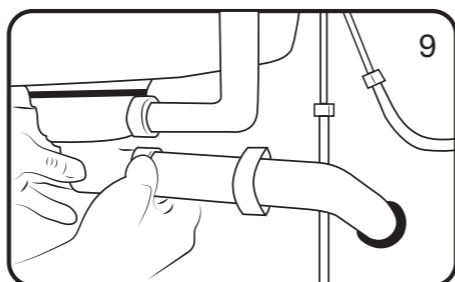

9



IMPORTANTE: Para la instalación SLIM o ENRASADO, si la encimera tiene un espesor superior a 16mm se deberá realizar un mecanizado en la parte posterior de la encimera para poder colocar el rebosadero. El centro del agujero del grifo debe realizarse a una distancia de 6 cm desde el corte de la encimera.

IMPORTANT: for the SLIM and flat inset installation, take the thickness of the countertop into consideration. If it is greater than 16mm, machining must be done on the back side of the countertop in order to place the overflow. The centre of the faucet hole must be placed at a distance of 6cm from the cut of the countertop

2. INSTALACIÓN ENRASADO

2. FLAT INSET



1

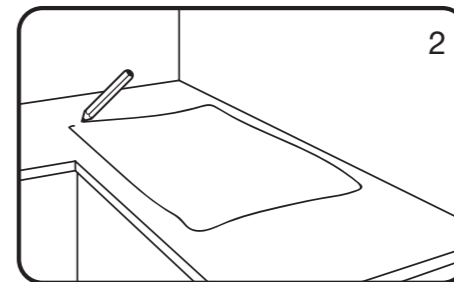

2

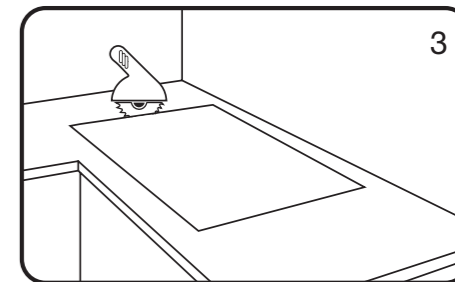

3

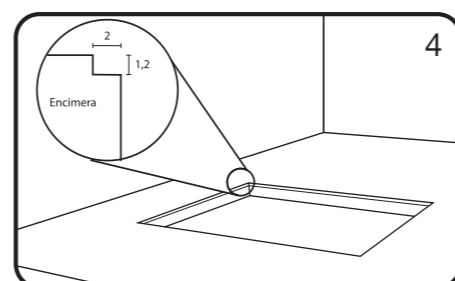

4

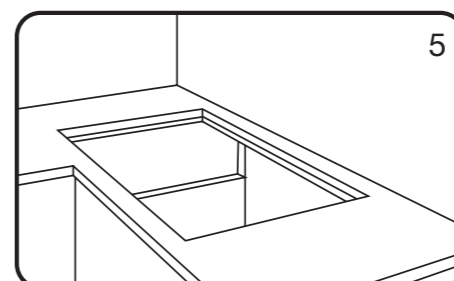

5

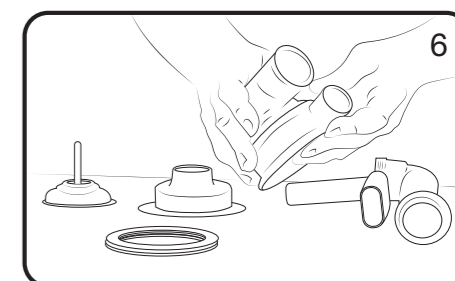

6

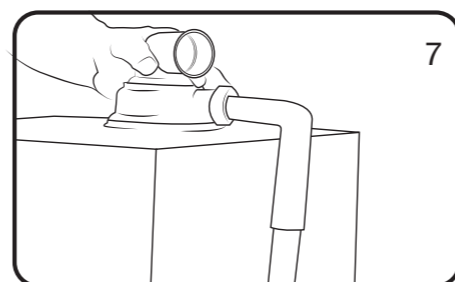

7

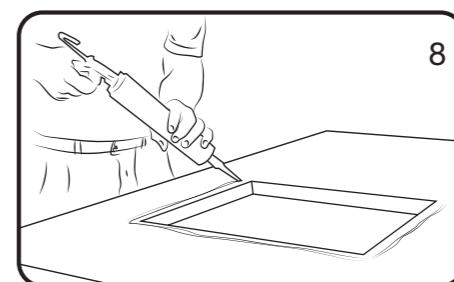

8

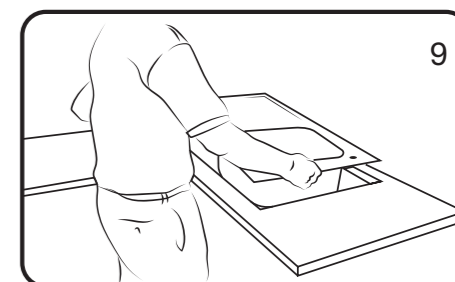

9

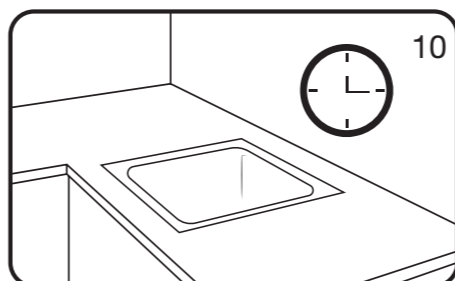

10

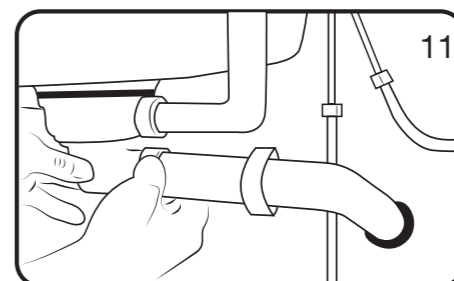

11